



## Manual

CCT Remote (2.4G)  
Model No.: HR02 / HR02B

### Features

- Color temperature / Brightness dimmable
- 2.4G RF wireless transmission technology
- Control distance 30m
- 4 Zones individual control, countless lights in each zone
- Support to save 4 scenes

### Parameters

Model No.: HR02 / HR02B  
Battery: 3V (CR2032\*2PCS)  
Standby Power Consumption: 3μA  
Transmitting Power: 6dBm  
RF: 2.4GHz  
Control Distance: 30m  
Working Temperature: -20~45°C

### Remote control

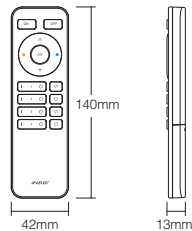

### Magnetic base holder

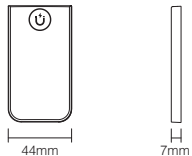

### Battery Installation

User need to buy battery separately,  
please pay attention to battery “+”  
and “-”

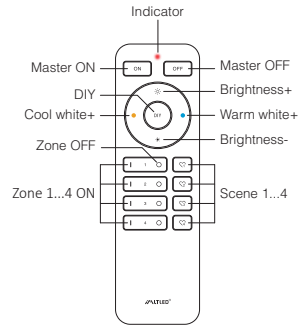
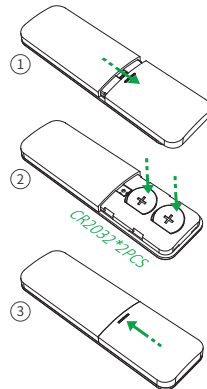

- | **Short Press:** Turn on light  
**Long Press 2S:** Maximum brightness
- **Short Press:** Turn off light  
**Long Press 2S:** Activate night light mode
- ♡ ... ♡ **Short press:** Activate scenes  
**Long press:** Save scenes

### Linking Code

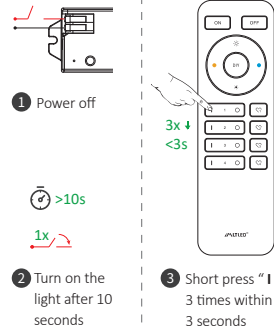

Linking code is done if the lights  
flashes 3 times slowly. You only can  
link lights into one zone on one remote.

## Cleaning Code

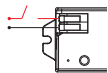

1 Power off

>10s

1x

2 Turn on the light after 10 seconds



Cleaning code is done if the lights flashes 6 times quickly.

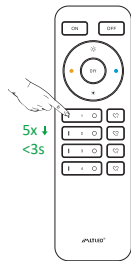

5x ↓  
<3s

3 Short press "I" 5 times within 3 seconds

## Copying Function

The remote have copying function. It can copy linking data from other remote. Users don't need to link current remote if copying data successfully.

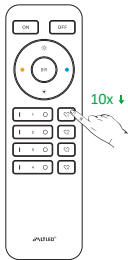

10x ↓



1. Activate copying function: Press "I" 10 times continuously

2. Press any button from another remote to finish copying.



Copying is done if indicator flashes 3 times slowly.

## Clean Copying

Press "I" continuously 15 times until indicator flashes 6 times.

## Time Setting (ON/OFF light)

**0.5S:** Press "I" 10 times continuously until the light flashes 2 times.

**1.5S:** Press "I" 15 times continuously until the light flashes 2 times.

## DND Mode ( ON/OFF)

**ON:** Press "I" 10 times continuously until the light flashes 4 times quickly.

**OFF:** Press "I" 15 times continuously until the light flashes 4 times slowly.

## PWM Frequency (High/Low)

**High:** Press "I" 10 times continuously until the light flashes 1 times.

**Low:** Press "I" 15 times continuously until the light flashes 1 times.

**Attention:** The different frequency can avoid the beeping noise from mains.

## Mini Brightness

1. Long press "O" or "OFF" 6S in any group zones until lighting fixture flashes one time (step out automatically if remote don't be operated within 5S).
2. Short press "O" or "OFF" to set up 10 different levels(1%, 5%, 10%, 15%, 20%, 25%, 30%, 35%, 40%, 45%, 50%). Press any button to step out.

## "DIY" Button Instruction

**Factory default**

**3 Brightness levels (Max → Middle → Low)**

Short Press zone "1"  
15 times continuously



15x ↓

**3 color temperature levels (CW → Neutral → WW)**

Short Press zone "2"  
15 times continuously



15x ↓

**On → OFF**

Short Press zone "3"  
15 times continuously



15x ↓

**Night Light → OFF**

Short Press zone "4"  
15 times continuously



15x ↓



Configuration is done while indicator of remote flashes 3 times

## Attention

1. Pay attention to battery "+" and "-" while doing installation.
2. It's better to remove battery if you don't use remote frequently.
3. Don't use remote near metal or magnetic area.



For more information, scan QR code

Made in China

